

# Architectural Elements Booklet

A look at five elements that can be  
found in the architecture of Maryland.

Wall Types, Door Types, Window Types,  
Roof Types, and Brick Bond Types.

Jessica Lewandowski  
ARCH 101 • Prof. McManus  
Assignment # 3



# Wall Types

# Wall Types

There are many different types of walls that can be used in architecture and the built environment. Some types are more decorative, some are praised for their structural abilities. In Maryland, where I live, and am currently working from home this semester, there is also a variety of different wall types that can be found. This also includes many historic stone built cabins and houses from the colonial period.

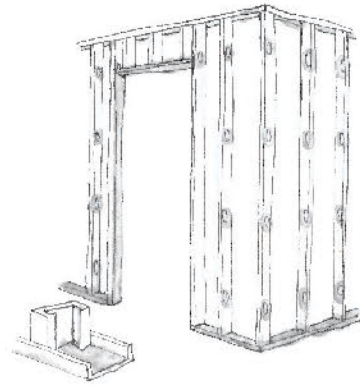

Metal Stud wall

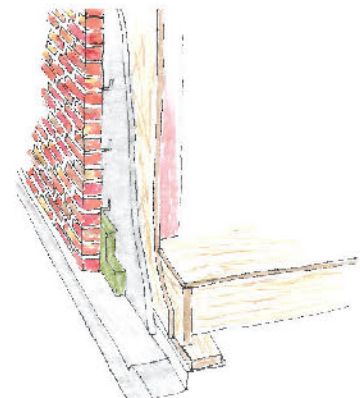

Brick Wall

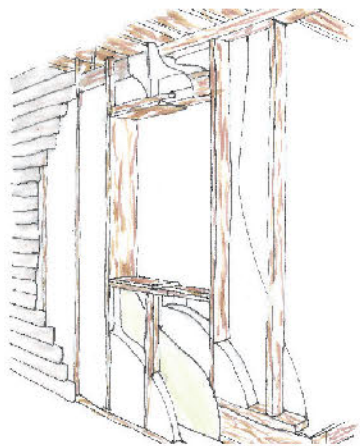

Wood Stud Wall

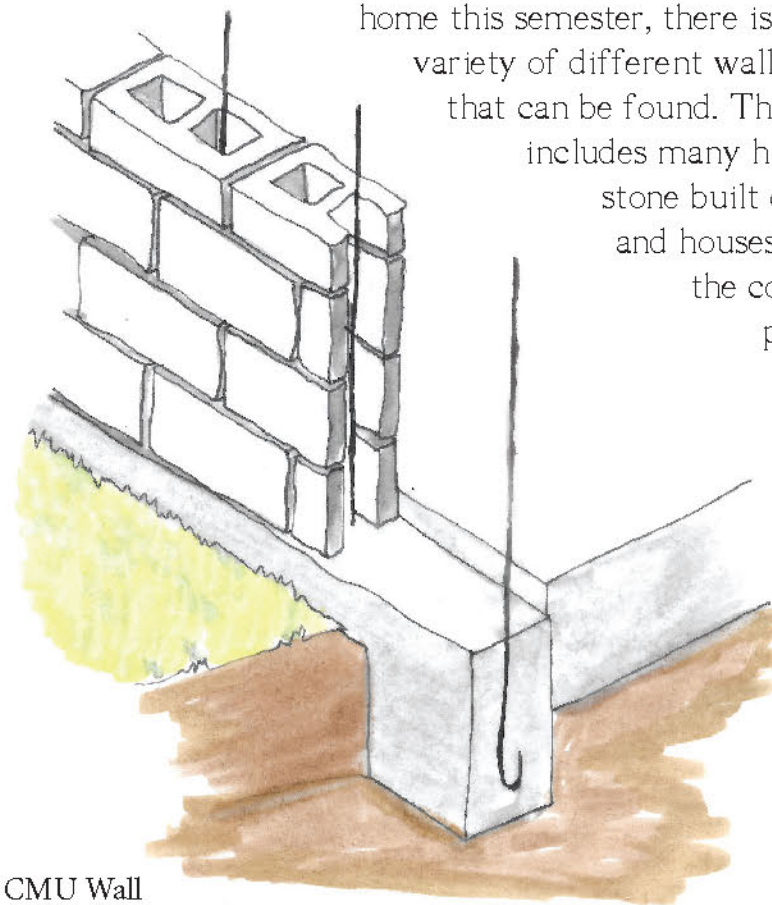

CMU Wall

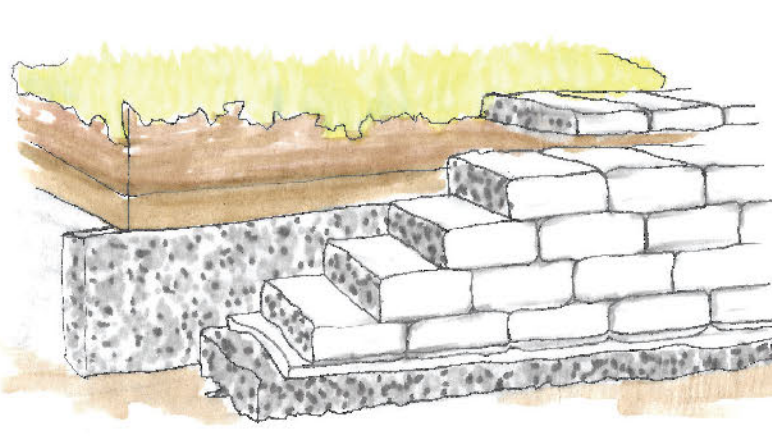

Stone Block Retaining Wall

## Structural Wall Types



## Interior Wall Finish Types

Interior wall finish types are of a wide variety and here are only a few examples. The most basic is a typical gypsum wall that can be covered over with paint, wallpaper, or any other veneers available. Cork, wood, and peg boards are some ideas to create a unique wall design. There is also a trend in design that enhances the exposed structural materials like brick and concrete block.

There are many different wall types found in Maryland many of which have a historic charm. These show that even after hundreds of years the basic modes of wall construction are relatively the same.



Pictured top left is the 1714 Hager House in Hagerstown, constructed of stone blocks.



Pictured top right is an 1810 brick Federal style town home in Georgetown, Washington D.C.



Pictured bottom right is a stone retaining wall located on Main Street, in downtown historic Ellicott City.



111

# Brick Types

# Brick Types

America, especially the north east where the original colonies were formed and the major ports are located have a conglomerate of brick bonds because of the diverse array of immigration from all over the world. The port of Baltimore was a popular seaport on the Chesapeake Bay and is why Maryland has many different types of brick bonds within the architecture found here.

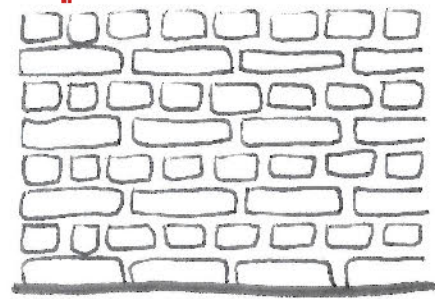

English Bond

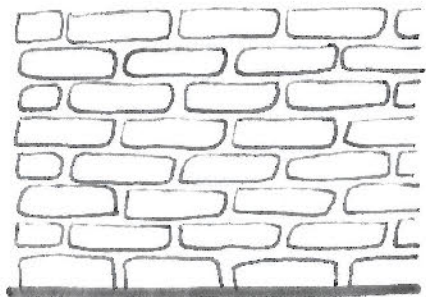

Stretcher Bond

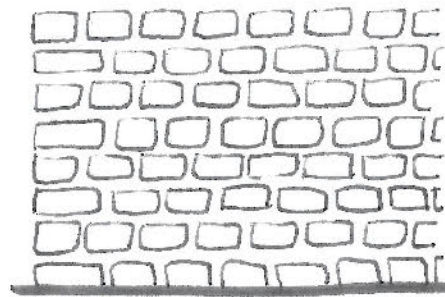

Header Bond

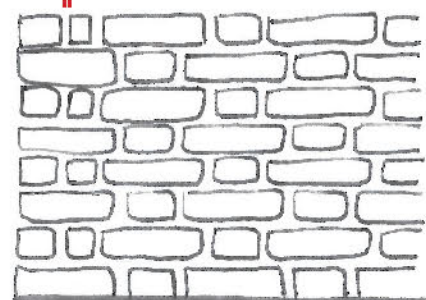

Flemish Bond

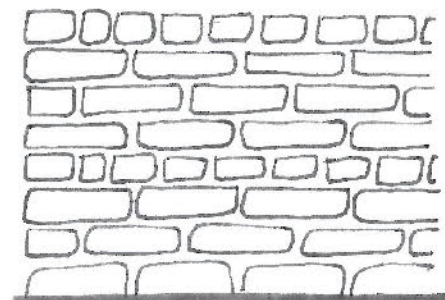

English Garden Wall Bond

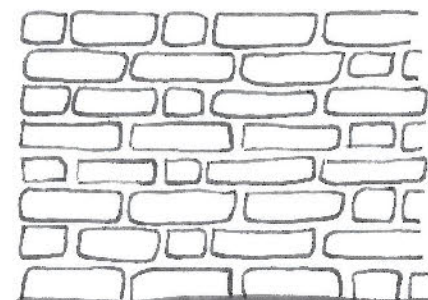

Flemish Garden Wall Bond

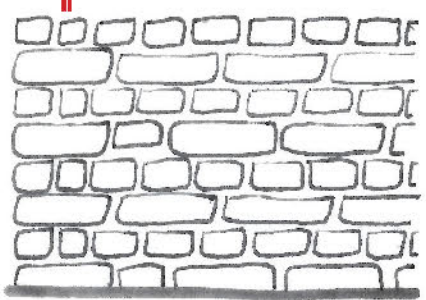

English Cross Bond

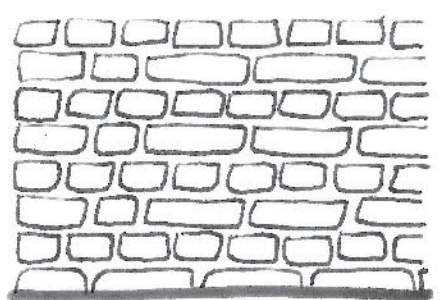

Dutch Bond

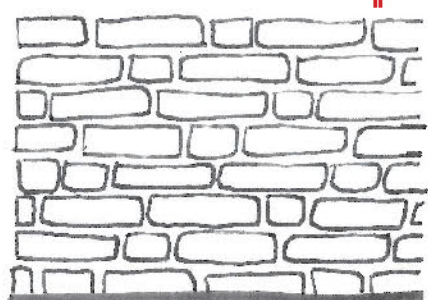

Monk Bond



## Brickwork

Pictured bottom left is the 1748 Clifton House in Silver Spring, with a detail of the brickwork pictured above in the upper left.

Pictured top middle is an old firehouse home in Cumberland.

Pictured bottom middle is the 1892 Hender Creamery in Baltimore.

Pictured top right are row-homes in downtown Baltimore.

There are six types of positions for the standard brick that make up the different compositions of unique brick bond patterns. There is the stretcher, soldier, header, rowlock, shiner, and sailor.

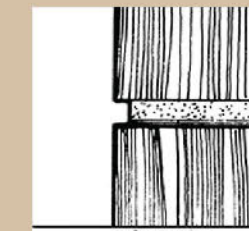

Raked Joint

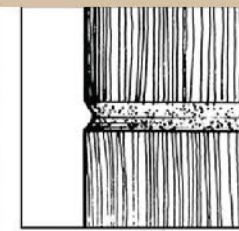

V-Joint

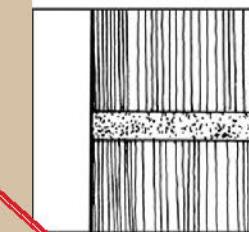

Flush Joint

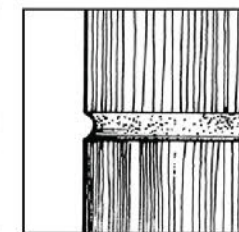

Concave Joint



There are also many different brick mortar joint techniques used between the rows of bricks that not only displays the skill level of the mason, as some are more difficult to execute than others, but also serve as decorative and each have different levels of water-resistance properties.

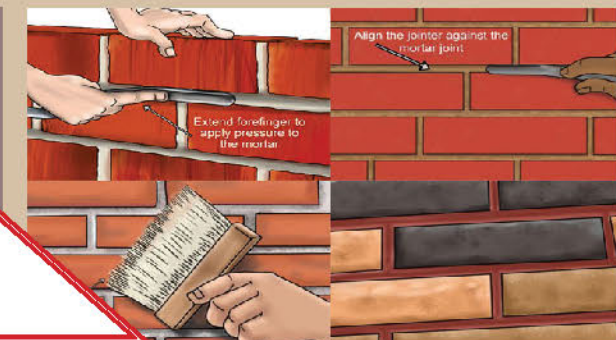



# Roof Types

# Roof Types

There are a plethora of roof types all with their unique purpose and applications. Below are some of the most common roof types. In residential and farm buildings it is common to see Gable, Hip, Gambrel, and Shed roof types. In commercial buildings you tend to see flat roofs, which are not entirely flat to ensure proper drainage.

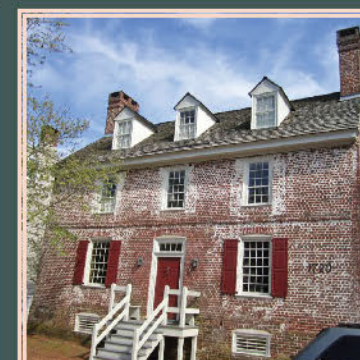
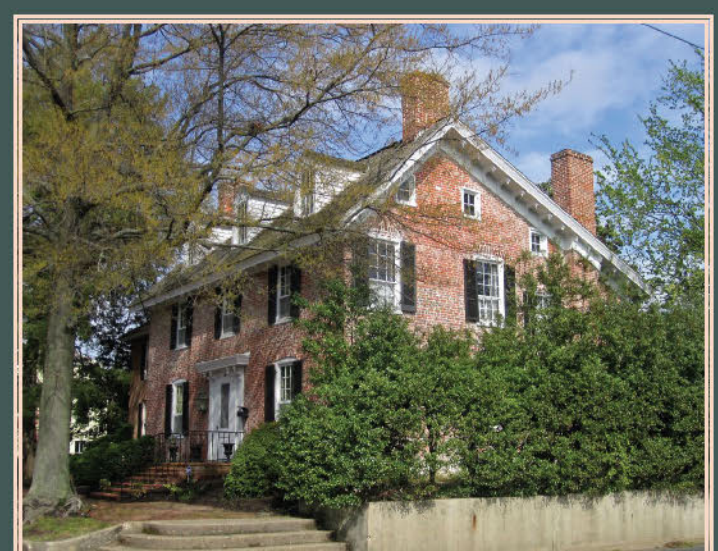
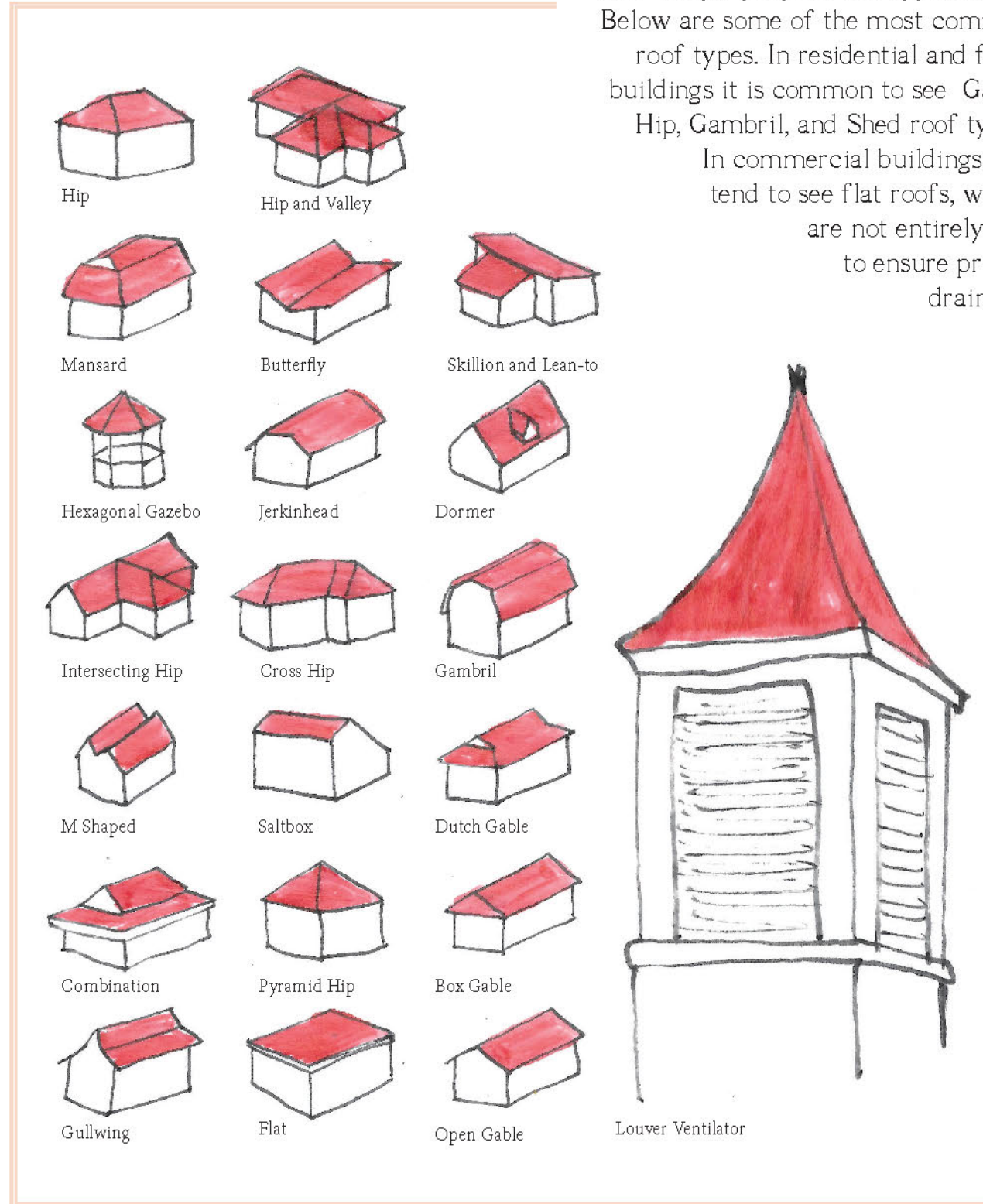

## Roof Types

Pictured bottom right is the 1800 Perkins House in Chestertown. Pictured bottom left is the 1905 Lamar Surgical Suite and current Civil War Museum in Middletown. Pictured middle left is the 1733 William and Mary University Presidents house in Williamsburg, VA. Pictured middle right is a 1935 Post Office in Hyattsville. Pictured top left is the 1703 Stottlery Plantation in Hollywood, Maryland overlooking the Patuxant River. Pictured top right is a 1759 residence in Chestertown.

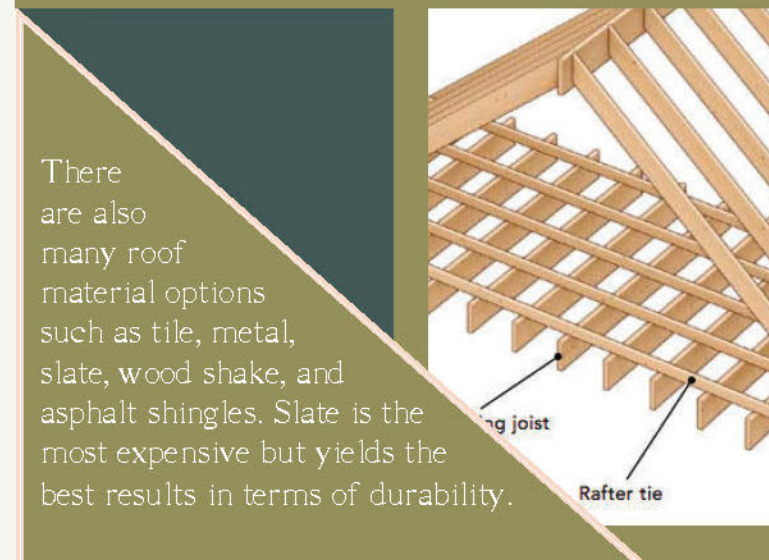

There are also many roof material options such as tile, metal, slate, wood shake, and asphalt shingles. Slate is the most expensive but yields the best results in terms of durability.



There are some critical components to consider when you are designing a roof. One element to be considered is the use of a parapet. This is where the roof extends past the wall underneath creating shade. This is great for home windows that face south.

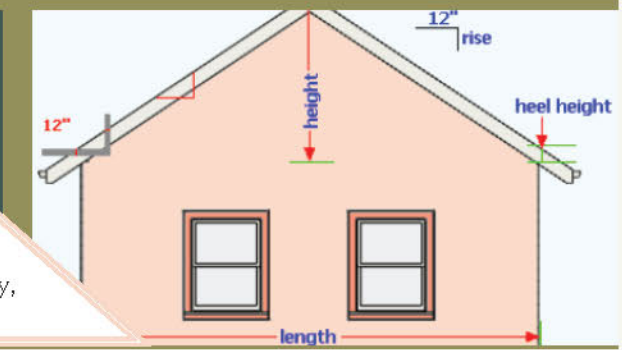

Another critical thing to remember when creating a roof is the slope and the desired pitch. This factor determines what type of materials can be used in each instance, the amount of attic space, drainage options, weather durability, design, maintenance, and the difficulty of construction.



# Window Types

# Window Types

There are many window types including the standard double hung window that most American houses are outfitted with today. Since the origin of the construction of habitable structures windows have been an important architectural element. Originally they were used not only to let in light, but to also look out for possible predators.

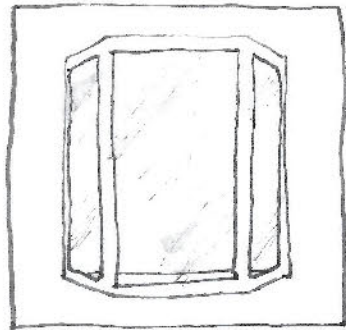

Bay

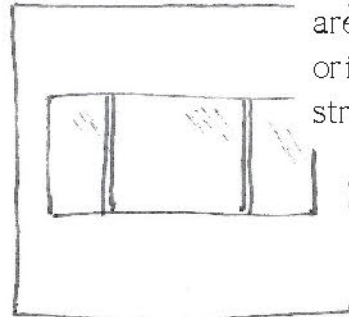

Three-Panel Slider

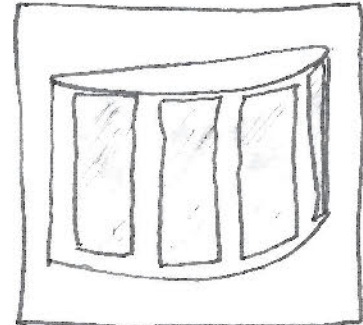

Bow

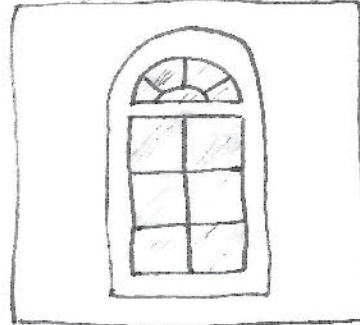

Arched

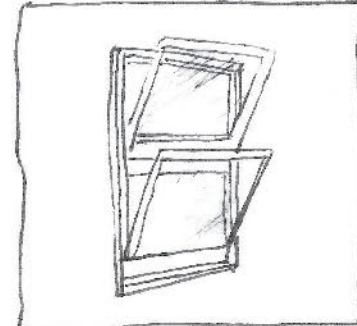

Double Hung

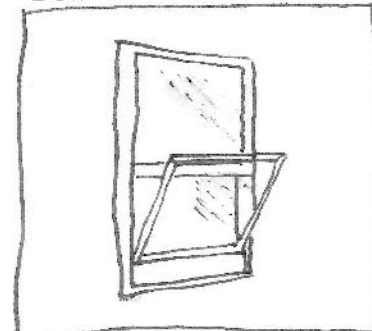

Single Hung

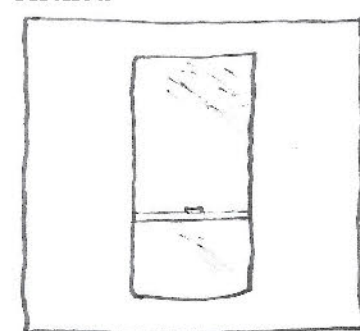

Oriel

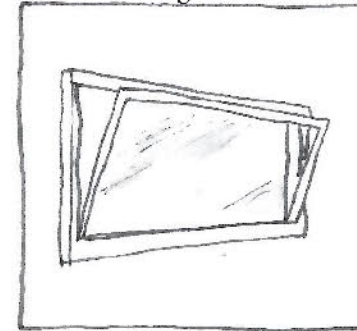

Hopper

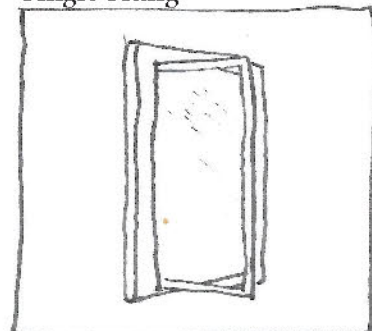

Casement

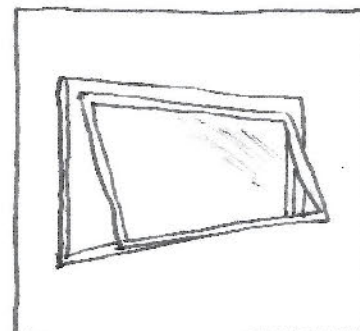

Awning

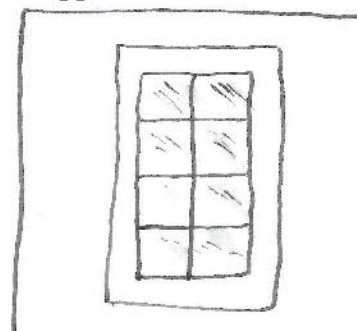

Transoms

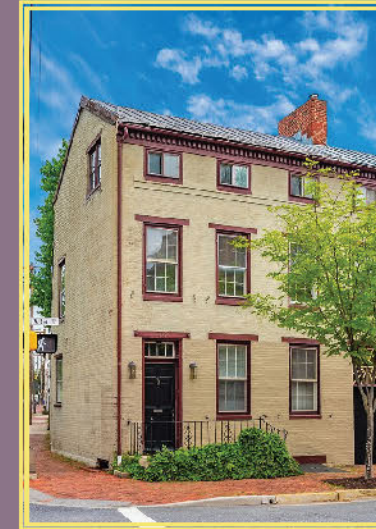

## Windows

Pictured bottom left is the 1927 reconstruction of the 1800's Barbara Fritchie house that was washed away during a storm. Pictured top left is an 1880 townhouse in downtown Frederick. Pictured top middle is the Fudge and Ice Cream Shop in downtown Frederick, originally built in 1940. Pictured top right are town houses in downtown Frederick.

I live just a short distance away from Frederick, Maryland. There are a lot of historic buildings tucked away downtown and they feature a lot of different and interesting window types.



Pictured top is the Maven Beauty Bar in historic downtown Frederick.

Pictured bottom is the Volt restaurant building built in the late 1800's Frederick.





# Door Types

# Door Types

You would not think about something as simple as a functional door having so many shapes, sizes, and functions. Here are a just a few different door types with some really unique ones I found as well.

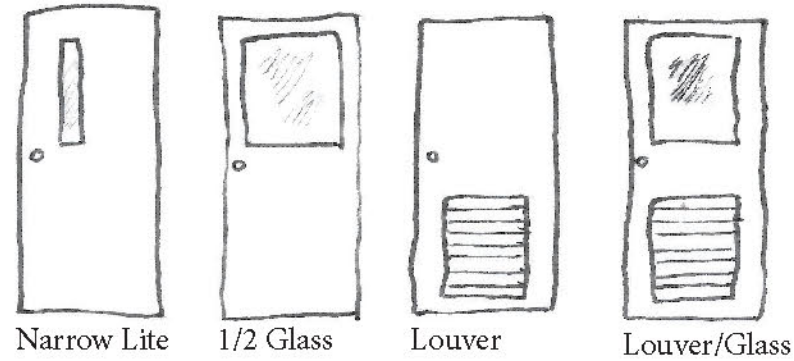

Narrow Lite    1/2 Glass    Louver    Louver/Glass

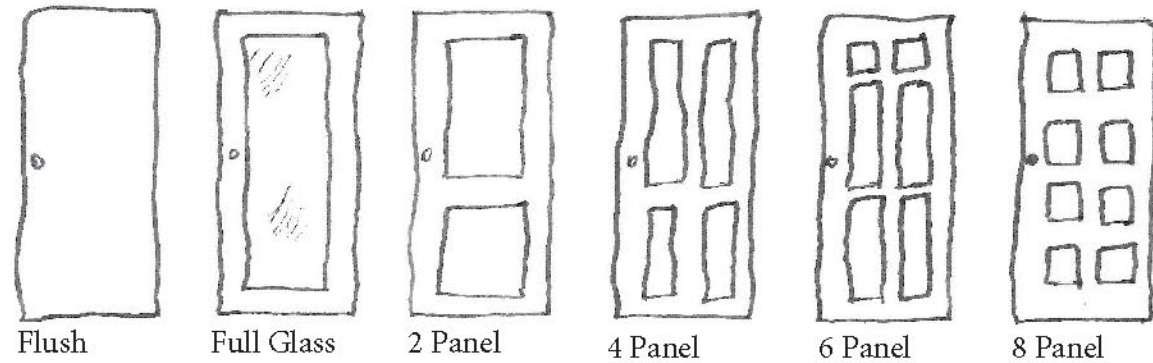

Flush    Full Glass    2 Panel    4 Panel    6 Panel    8 Panel

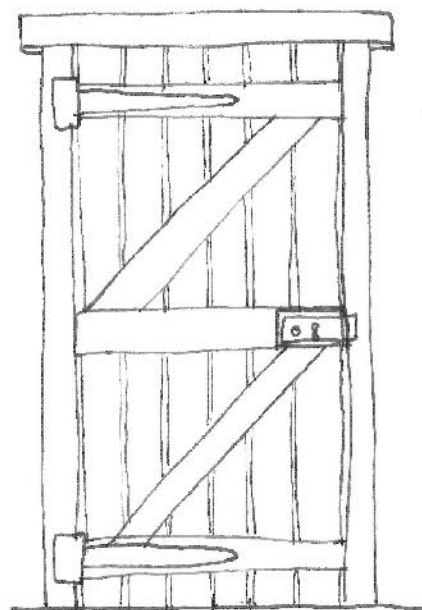

Above: Batted, Ledged, and Braced. Right: Dutch



## Door Types

Pictured bottom left is Sean Bolan's Irish Pub in downtown Bel Air, built in 1900.  
 Pictured left middle is the Town Hall of Mount Airy located on Main Street in downtown.  
 Pictured right middle is the Country Store Museum located on Main Street in downtown Mount Airy.  
 Pictured top left is 1 North Main Street, Mount Airy an old train station once part of the B&O Railroad.  
 Pictured top right is 404 South Main Street, a 1900 built residence in downtown Mount Airy.

After living in Savannah for school, it is interesting to see the differences and similarities in door types found both there, in old southern homes and those found where I am from in Maryland.



Pictured top left is a type of jib door. This often frame less door type is meant to blend into its surroundings carrying on the design of the walls or casegoods around it such as a bookshelf.

Pictured top right is a type of jib window. Although, called a window this type of framed fenestration can be opened and used like a door. It was very common in old southern plantation homes and can even be found in Victorian homes to access the porch or have a good cross breeze to cool the home.

Pictured bottom right is a type of bulk head door most commonly used to access cellars or seek shelter in the event of a storm or tornado.



<https://www.shutterstock.com/video/clip-1015990141-architectural-blueprints—plan-modern-house>  
[https://en.m.wikipedia.org/wiki/Sotterley\\_\(Hollywood,\\_Maryland\)#/media/File%3ASotterley\\_Jul\\_09.JPG](https://en.m.wikipedia.org/wiki/Sotterley_(Hollywood,_Maryland)#/media/File%3ASotterley_Jul_09.JPG)  
[https://www.fredericknewspost.com/news/arts\\_and\\_entertainment/history/middletown-civil-war-museum-for-sale/article\\_30fd55bb-5305-5fe4-ae10-796c58f70cd4.html](https://www.fredericknewspost.com/news/arts_and_entertainment/history/middletown-civil-war-museum-for-sale/article_30fd55bb-5305-5fe4-ae10-796c58f70cd4.html)  
<https://www.spikevm.com/how-to/roof-pitch.php><https://www.almeidaroofting.com/>  
<https://www.finehomebuilding.com/2013/11/07/how-it-works-collar-and-rafter-ties>  
<https://www.ipwatchdog.com/2017/05/23/drywall-augustine-sacketts-gypsum-board-construction/id-83491/>  
<https://www.renovate.org.nz/1970s/foundations-and-subfloors/foundations-original-details/foundation-walls/>  
<https://wanderwisdom.com/travel-destinations/Row-House/The-history-of-Baltimore-Row-houses>  
<https://www.thisoldhouse.com/curb-appeal/21018589/12-spring-fix-ups-that-save-you-money>  
<https://www.classicist.org/articles/classical-comments-english-bond-and-its-kin/>  
<https://www.bhg.com/home-improvement/walls/how-to-frame-with-metal-studs/>  
<https://www.apartments.com/beautiful-downtown-frederick-frederick-md/leyvyhd/>  
<https://www.flickr.com/photos/11537676@N06/5747252233/in/set-72157626646591445>  
<http://www.ellicottcity.net/tourism/attractions/ellicott-city-fire-station/>  
<https://www.housebeautiful.com/home-remodeling/a27574141/jib-door/>  
<https://www.lat-works.com/different-of-in-ppt-types-brick-bonds>  
<http://www.quantity-takeoff.com/brick-mortar-joints-in-masonry-construction.htm><https://www.familyhandyman.com/masonry/how-to-repair-mortar-joints/><https://ewistore.co.uk/types-of-trowel-for-ewi-and-render/>  
<https://www.longandfoster.com/MD/Frederick>  
<https://www.frederickhopsandvinestours.com/gallery>  
<https://www.pinterest.com/pin/262194009527380403/>  
<https://www.milgard.com/blog/what-french-door>  
<https://dopesontheroad.com/lesbian-travel-guide-frederick-md/>  
[https://en.m.wikipedia.org/wiki/United\\_States\\_Post\\_Office%E2%80%990793Hyattsville\\_Main#/media/File%3AHyattsville\\_PO\\_Nov\\_08.JPG](https://en.m.wikipedia.org/wiki/United_States_Post_Office%E2%80%990793Hyattsville_Main#/media/File%3AHyattsville_PO_Nov_08.JPG)  
<http://www.theveraciousvegan.com/2013/05/volt-frederick-md.html>  
<https://downtownfrederick.org/item/barbara-fritchie-house/>  
[https://en.m.wikipedia.org/wiki/Hager\\_House\\_\(Hagerstown,\\_Maryland\)](https://en.m.wikipedia.org/wiki/Hager_House_(Hagerstown,_Maryland))  
<https://www.flickr.com/photos/via/5769730099/in/photostream/>  
<https://sah-archipedia.org/buildings/MD-01-031-0075>  
<https://www.next.cc/journey/discovery/wall-sections>  
<https://www.greenbuildingadvisor.com/green-basics/brick>  
<https://www.ourtime.org/types-of-interior-wall-materials/>  
<https://www.homestratosphere.com/drywall-alternatives/>  
[https://en.m.wikipedia.org/wiki/Hendler\\_Creamery](https://en.m.wikipedia.org/wiki/Hendler_Creamery)  
<https://www.longandfoster.com/MD/Bel-Air>  
<http://www.jacobsenarchitecture.com/n-street-trust>  
<https://www.colonialwilliamsburg.org/>  
<https://www.homedit.com/dutch-door/>  
<http://kilduffs.net/travels-through-maryland/old-maryland-and-train-stations/mt-airy-train-station-carroll-county-maryland/>

Image  
Credits